

## ALARM CHECK VALVE, VERTICAL TRIM Flange Ends, 300PSI

### FIG · F1511-300

#### Specification

- Valve must be installed in vertical position with the trim as shown. Any deviation may affect the proper operation of the valve.
- Flange designed to EN1092-2 PN10/16, ANSI B16.1 Class 125 or BS10 Table D/E (Other types available on request).
- UL listed.
- Working pressure:  
Cold water, 300PSI,  
200PSI or 250PSI available on request.
- Corrosion protection:  
Internally and externally fusion bonded epoxy powder coated (FBE).

#### Note:

*Design and material are subject to change without notice.*

#### Schematic

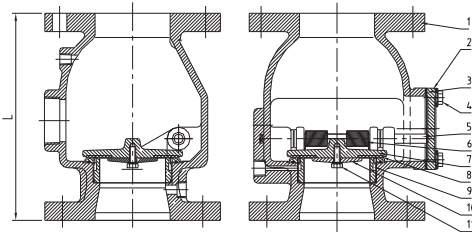

#### Material Specification

No.	Part Name	Material	ASTM Spec.
1	Body	Ductile Iron	A536 65-45-12
2	Cover	Ductile Iron	A536 65-45-12
3	Gasket	Rubber	EPDM
4	Bolt	Carbon Steel	A307B
5	Stem	Stainless Steel	AISI 304
6	Spring	Stainless Steel	AISI 304
7	Disc	Ductile Iron	A536 65-45-12
8	Disc Ring	Rubber	EPDM
9	Seat	Bronze	B62 C83600
10	Retainer	Brass	B16 C36000
11	Bolt	Stainless Steel	A2-70

#### Dimensions (mm)

Size	80	100	150	200
L	257	270	340	432

#### Schematic of Valve with Accessories

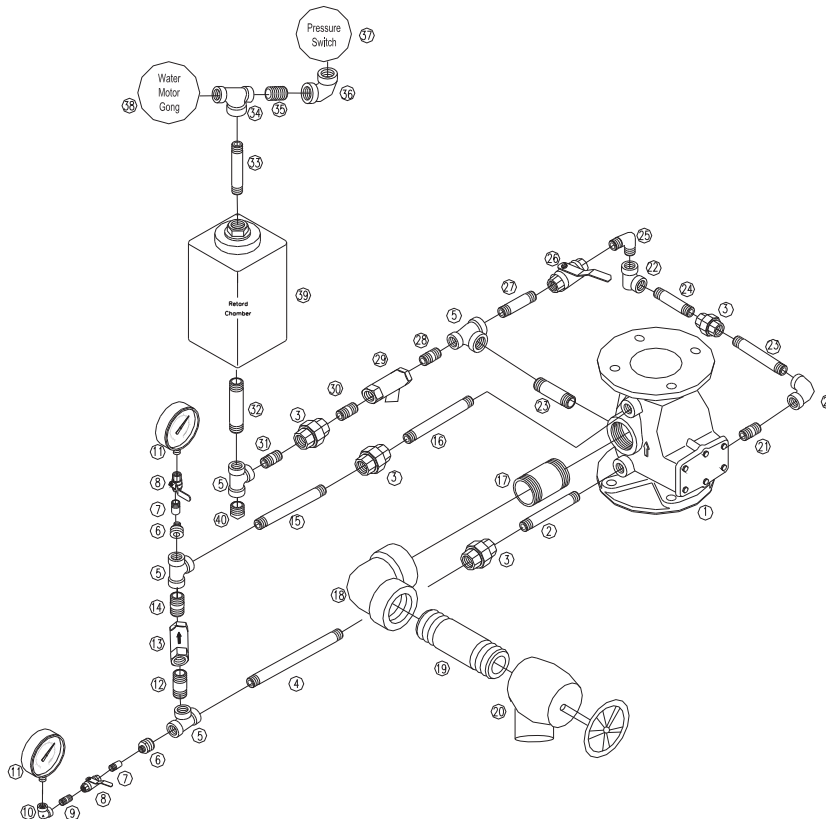

Part No.	Specification	Material
1	Valve	See Above
2	Pipe Fitting	AISI 304
3	1/2" Union	AISI 304
4	Pipe Fitting	AISI 304
5	1/2" X 1/2" X 1/2" Tee	ASTM B16 C36000
6	1/2" M-1/4" F Nipple	ASTM B16 C36000
7	Pipe Fitting	AISI 304
8	1/4" Ball Valve	ASTM B16 C36000
9	Pipe Fitting	AISI 304
10	1/4" 90° Elbow	ASTM B16 C36000
11	Pressure Gage	
12	Pipe Fitting	AISI 304
13	1/2" Check Valve	ASTM B16 C36000
14	Pipe Fitting	AISI 304
15	Pipe Fitting	AISI 304
16	Pipe Fitting	AISI 304
17	Pipe Fitting	AISI 304
18	2" 90° Elbow	AISI 304
19	Pipe Fitting	AISI 304
20	2" Angle valve	ASTM B16 C36000
21	Pipe Fitting	AISI 304
22	1/2" 90° Elbow	ASTM B16 C36000
23	Pipe Fitting	AISI 304
24	Pipe Fitting	AISI 304
25	1/2" 90° Elbow	ASTM B16 C36000
26	1/2" Ball Valve	ASTM B16 C36000
27	Pipe Fitting	AISI 304
28	Pipe Fitting	AISI 304
29	1-2" Y-Strainer	ASTM B16 C36000
30	Pipe Fitting	AISI 304
31	Pipe Fitting	AISI 304
32	Pipe Fitting	AISI 304
33	Pipe Fitting	AISI 304
34	3/4" Tee	ASTM B16 C36000
35	Pipe Fitting	AISI 304
36	3/4" x 1/2" 90° Elbow	ASTM B16 C36000
37	Pressure Switch	
38	Water Motor Gong	
39	Retard Chamber	
40	1/2" Plug Screw	AISI 304